

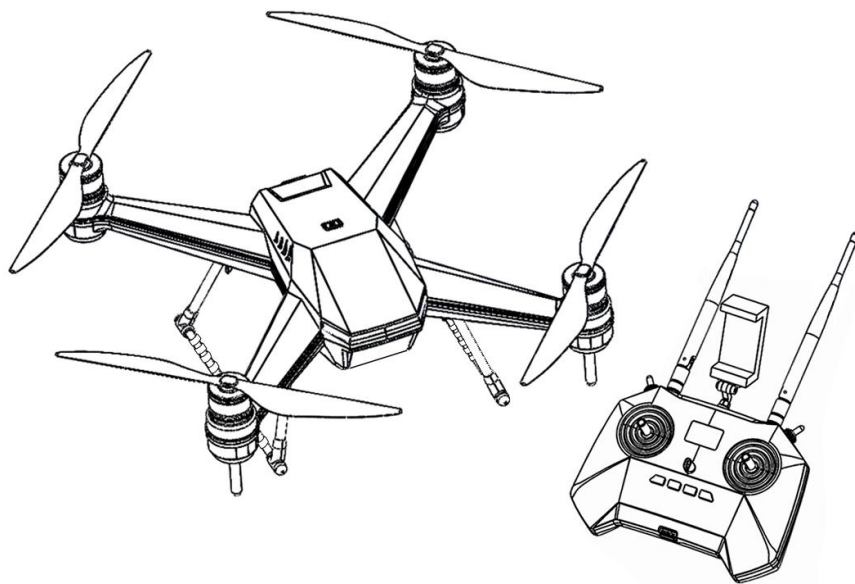

# SMART FISHING DRONE

## Quick Start Guide

V13:20220629



### Download the Rippton App

Search for “Rippton” on the Google Play Store, Samsung Galaxy Apps or App Store to install the app on your mobile device or scan this QR code.

**\*\*\*Notice** this manual is for the SharkX but also applicable to the SharkX Plus and the SharkX Pro. The SharkX is the basic model while the Plus and the Pro are upgraded versions so they include additional functions and features. Therefore, all the charts and graphics in this manual are just for a general reference and should be subject to actual applications and updates.

## SHARKX

SHARKX is a professional smart fishing drone, which is capable of lifting up to **3 KG** baits over the water where you go fishing. Together with the use of the 'RIPPTON' App, SHARKX can fly to any fishing spots within a distance of **1 KM** away from the home point by tapping the GPS map on the 'Rippton' app, and all mission spots will be saved automatically after the missions have been completed.

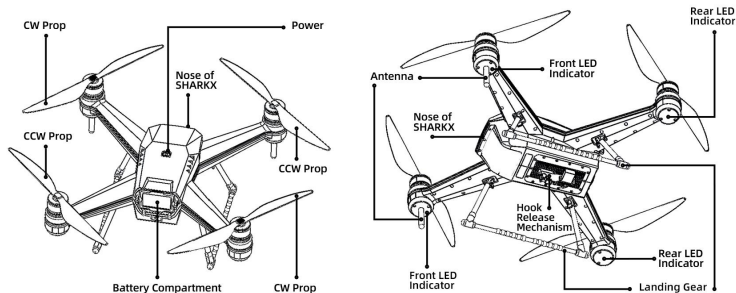

## Remote Control

The remote control allows users to fly the SHARKX to as far as 1 KM, with the buttons and dials for power on/off, hook releasing and return to the home point.

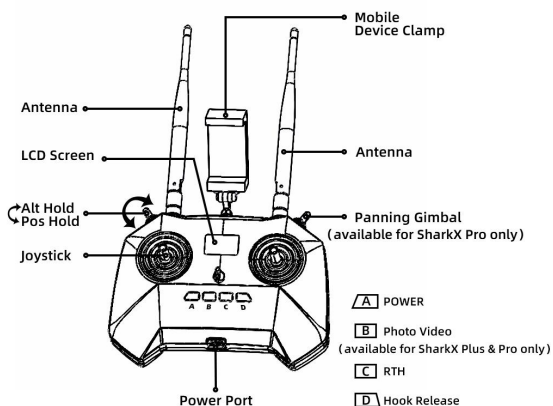

## Controls

Using remote control joysticks for vertical and horizontal flying, and locking and unlocking the drone.

### Control of drone while in the air

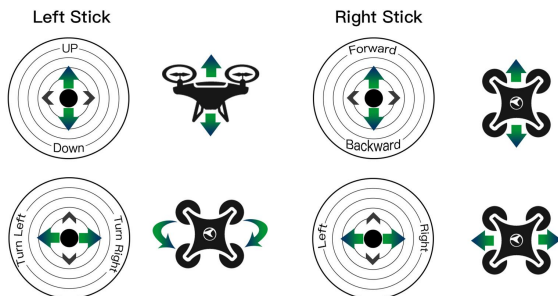

### Starting & Stopping Motors

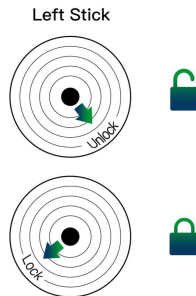

Using remote control to open and close the hook release mechanism

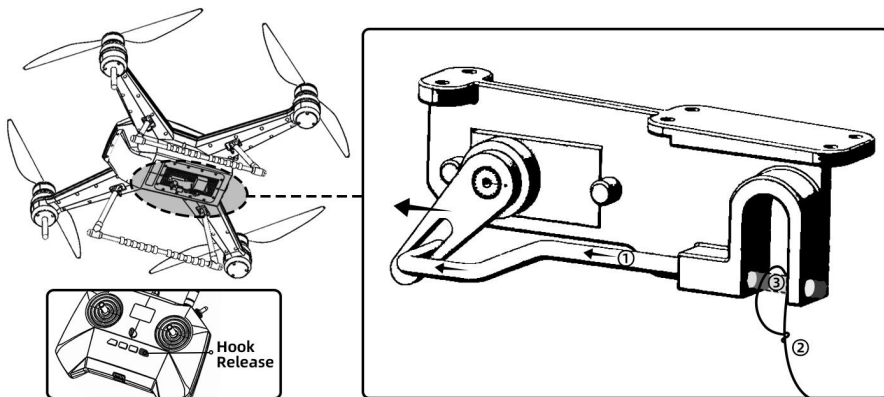

- ①. Press the 'Hook Release' button on the remote control to open the hook release mechanism.
- ②. Put the fishing line in the device.
- ③. Press the 'Hook Release' button on the remote control to close the hook release mechanism.

## Setup of SHARKX

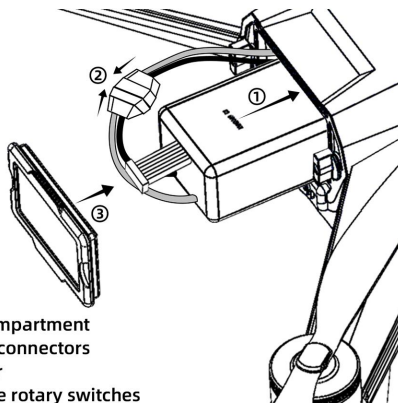
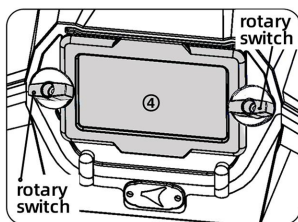

- ①. Insert the battery into the compartment
- ②. Connect and fasten the wire connectors
- ③. Close the compartment cover
- ④. Lock the cover by twisting the rotary switches

CCW Props

CW Props

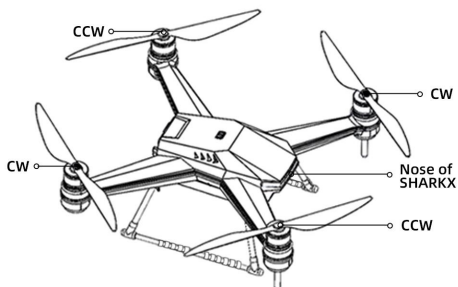
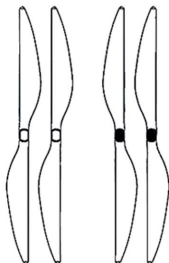

CW Propeller Installation

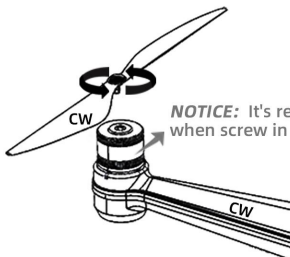

**NOTICE:** It's recommended to fix the motor when screw in the propellers.

CCW Propeller Installation

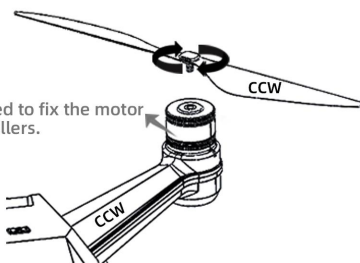

## Preparation of the Controller

**Notice:** for optimal range the sides controller antenna need to face the drone while it is in flight, and NOT point at the drone

1. Tilt the antennas up.

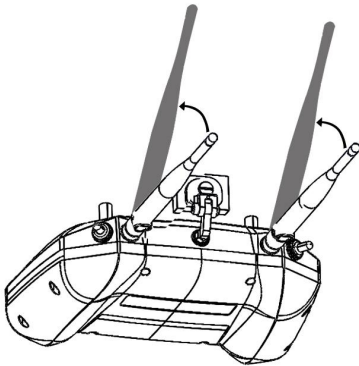

2. Fasten your mobile device securely to the clamp.

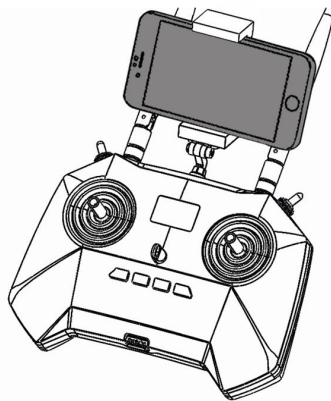

## Preloading the Map on the App

When using the SHARKX in any new areas, it's always necessary to enter the 'Rippton' app with network connection and finish preloading the map before connecting the SHARKX to your mobile device.

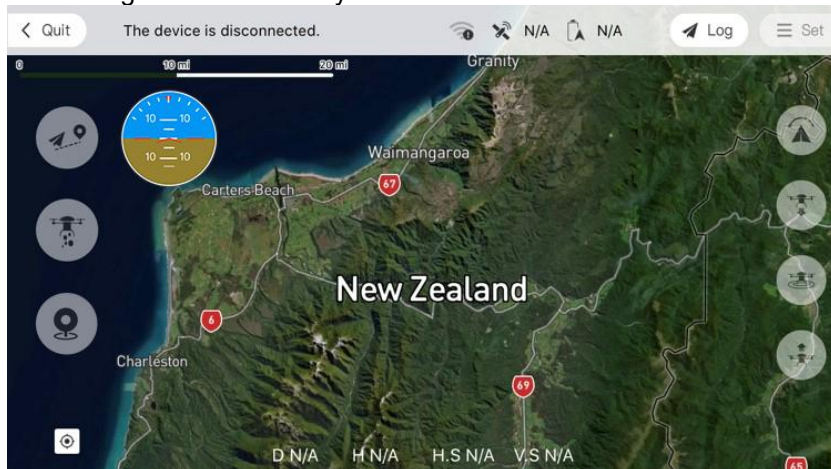

Connect the SharkX Controller to Your Mobile Device

1.With the remote switched on, search SHARKX WI-FI on your mobile device. The WI-FI name is 'SharkX\_XXXXXXXXXXXX'. And the original password is 12345678.



2.Enter RIPPTON App. Tap 'Device' on the home page.



3. Slide and find 'SharkX'.

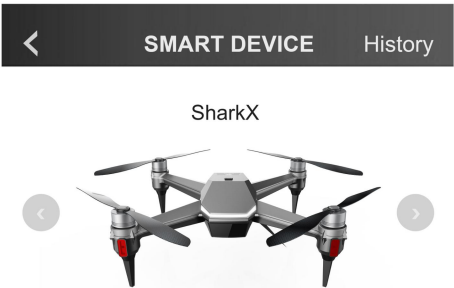

4.Tap 'Enter'.



Notice

- there is a voice prompt indicating SharkX connected successfully
- before launching SharkX, please make sure the satellite number is no less than 15, otherwise the drone will not take off successfully
- please do the calibration every time when you come to a new place, according to Section 4.5 of the User Manual

## Rippton App Function



### Mission Selection Button

Select automatic releasing fishing line mission



### RTH (Return to Home) Button

SHARKX will return to the home point and land on the ground



### Release Switch Button

To open or close the hook release mechanism



### Automatic Landing Button

SHARKX will land directly and stop its motors



### Spot Marking

Mark a spot during the flight



### Take-over Button

SHARKX will hover and switch to manual control



### Current Location

Return to the current location



### Automatic Take off Button

SHARKX will take off from the home point



### Satellite Number

Indicate the number of satellites providing the signal



### HOME Point

The position where the SHARKX takes off and returns to by default



### Drone Battery Level

Indicate the current battery level of SHARKX



### Attitude Indicator

Indicate the real-time attitude of SHARKX



## Annotation of Different Spots on App

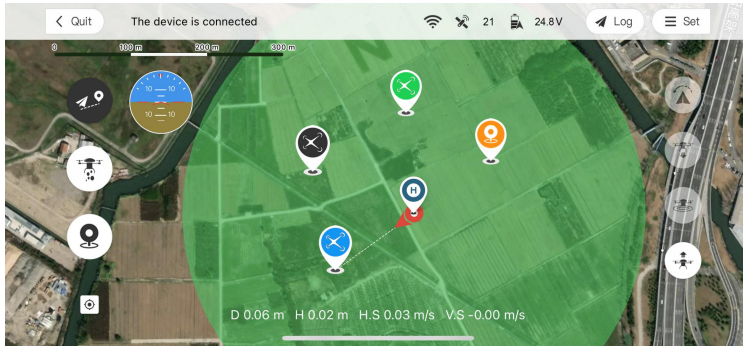

current mission spot



marked spot during flight



all historical mission spots



the latest historical mission spot



**ATTENTION**

1. If to take off or land on water, it's of vital importance to keep the drone within 50 meters from the remote controller. Otherwise, the drone might be out of control due to the connection failure between the drone and the remote controller;
2. Make sure that the controller, SharkX battery, and mobile device are fully charged;
3. Make sure that the propellers are mounted correctly and firmly;
4. Make sure that the mobile device clamp is mounted correctly and firmly;
5. Make sure that the hook release mechanism operates correctly;
6. Make sure the payload does not exceed 3KG;
7. Make sure that the Rippton App operates correctly and is connected;
8. Ensure the SharkX Controller keeps staying at "Pos Hold" Mode;
9. Make sure you have a large clear space around you, free of children, pets and People before attempting to fly;
10. Always have the nose of the drone facing away from you & nose facing the sea before takeoff.



## Charge the Drone Battery

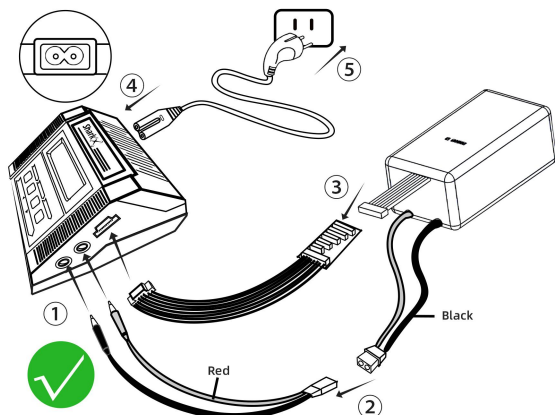

**WARNING** DO NOT POWER ON THE CHARGER AT THE WALL SOCKET UNTIL THE CABLES ARE ALL CONNECTED PROPERLY

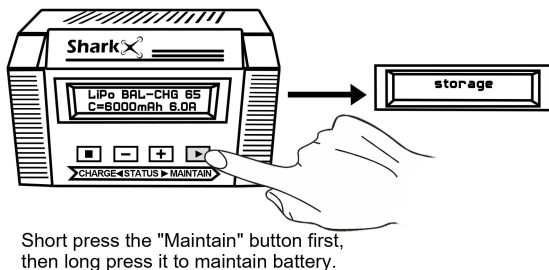
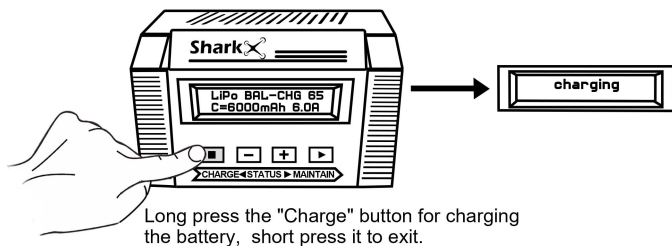

### Note:

Considering the potential battery-life loss caused by regular high-power fast charging, we recommend doing a battery **maintenance** every 3 months, which can protect the battery from the battery-life loss. When 'storage' appears on the screen, the charger will provide maintenance to the battery.

In the event that the battery has not been used for a long time (such as 1 month), it is recommended to perform a maintenance first before charging.

It normally takes approx. 2 hours to fully charge the drone battery.

## Charge the Remote Control

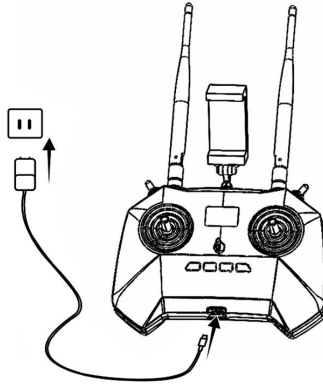

It normally takes approx. 3.5 hours to fully charge the remote control.

**Notice** regularly charge both the drone battery and remote control every two months to avoid the over-discharging, which may cause the batteries not to charge.

**For more details about SHARKX Preface, Description of the Product, Preparation and Installation, Operation/Use, Maintenance, Troubleshooting and Repair, Disposal information etc., please refer to the User Manual.**

**To watch the video of installation, app operation process, compass & IMU calibration, please scan the QR code below**



**For more information about Rippton, please scan the QR code below**



## Useful Tips:

### 1. How to use the RC to take over when the drone is controlled via the App?

Two ALTERNATIVE ways:

- tap the "Take-over" icon on the flying control interface; OR
- toggle the lever to 'Alt Hold' and then back to 'Pos Hold' on the remote control.

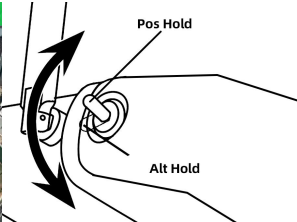
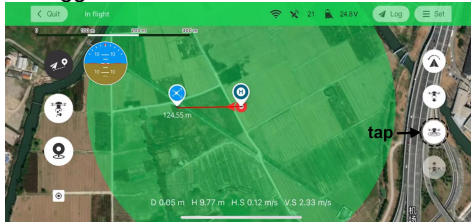

### 2. How to interrupt the ongoing automatic mission execution and start a new mission?

Two ALTERNATIVE ways:

- tap the 'Mission Selection' icon on the flying control interface; OR
- toggle the lever to 'Alt Hold' and then back to 'Pos Hold' on the remote control.

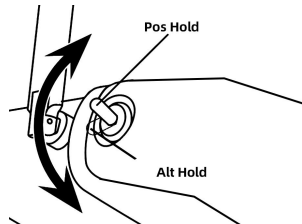
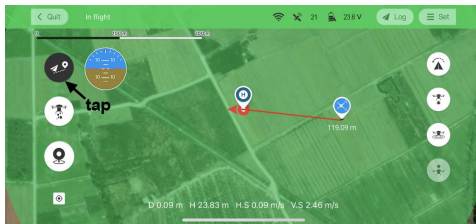

**Notice** it's recommended not to tap any icon on the interface during the automatic mission execution unless you decide to start a new mission.

Start a new mission:

- tap 'Mission Selection' to start a new mission;
- slide to start.

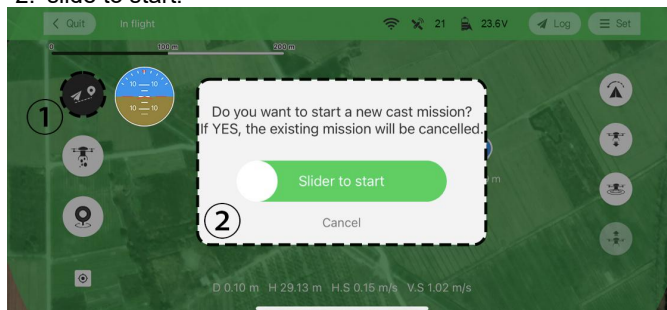

## Safety Notice

It's recommended to always keep the SHARKX within your visual range. Do not pull the fishing line if it got snagged with the drone. It may break the drone's balance.

## Specifications

### SHARKX Drone

Device Name	SHARKX Smart Fishing Drone
Weight	3.2 kg
Dimensions	480 x 480 x 215 mm (Propeller Closed)
Propeller	16 inches
Max Speed	10 m/s (36 km/h)
Max Payload	3.0 kg
Max Wind Resistance	10 m/s (36km/h)
Protection Level	Water Surface Floating
Operating Temperature	-10 °C to 40 °C
Operating Frequency	2400 ~ 2483.5 MHz
Transmitter Power (EIRP)	+20 dBm
Satellite Systems	GPS/GLONASS/GALILEO/BEIDOU
*Flying Time (Without Payload)	23 mins
*Suggested Casting Radius (With Payload)	0~1.0 km
Radio Technology	Wi-Fi Data Transmission Controller Spread Spectrum Wireless
Frequency Band	2.4 Ghz Wi-Fi Data Transmission 2.4 Ghz Controller Spread Spectrum Wireless
Operating Environment:	No trees; No obvious obstacles; No strong radio interference; No enroute area; No no-fly zone; Keep the drone within sight; Away from crowds.

### SHARKX Remote control

LCD Screen	0.96 inches
Operating Frequency	2400~2483.5 MHz
Max Transmission Distance (Unobstructed, Free of Interference)	1 km

### SHARKX Battery

Capacity	6,000 mAh
Battery Type	LI – PO